



**OPTIMUM  
ARMS**

**THE WISE CHOICE**

**INSTRUCTION MANUAL  
FOR  
OPT VM G1 20**

**WARNING: READ THE INSTRUCTIONS AND SAFETY PRECAUTIONS IN THIS MANUAL CAREFULLY BEFORE USING THE FIREARM**

**BEFORE USING YOUR SHOTGUN READ THE WARNINGS AND INSTRUCTIONS IN THE USER'S MANUAL CAREFULLY.**

**IMPORTANT WARNING!!!**

**INFORMATION AND SPECIFICATIONS CONTAINED IN THIS MANUAL MAY CHANGE WITHOUT NOTIFICATION.**

**CARE AND STORAGE OF OPT VM G1 20 SHOTGUN**

**1) NEVER ALTER OR MODIFY YOUR SHOTGUN**

This shotgun was produced under specific manufacturer guidelines and should not be changed under ANY

circumstances. Altering the trigger, mechanical components, safety mechanisms, or using any other products other

those provided in the original box is NOT RECOMMENDED by the manufacturer, and could result death, bodily harm, or compromising your safety or the safety of others. Any alteration made to the firearm also voids the factory warranty.

## **2. PROPER MAINTENANCE AND CARE**

It is essential that regular maintenance and cleaning performed to maintain the accuracy, function, and maximize the longevity of your shotgun. Before cleaning ALWAYS perform a safety check to make sure that the shotgun is unloaded prior to cleaning.

In order to achieve the best performance and reliability from your shotgun, please read and fully understand all of the instructions, safety guidelines, and warnings carefully in this manual.

Before using or firing real cartridges, you must thoroughly understand the parts, functions and working mechanisms of your shotgun. Accordingly, carefully read and understand the methods for using your shotgun safely and effectively, and the information about your shotgun parts.

**TECHNICAL SPECIFICATIONS**

<b>Model</b>	<b>OPT VM G1 20</b>
<b>Caliber</b>	<b>20</b>
<b>Working system</b>	<b>Gas Operated Semi-Auto</b>
<b>Curb Weight</b>	<b>3,2 Kg.</b>
<b>Total Length</b>	<b>100 cm.</b>
<b>Height</b>	<b>25 cm.</b>
<b>Barrel Length</b>	<b>50 cm.</b>
<b>Magazine Weight (empty)</b>	<b>300 gr.</b>
<b>Magazine Capacity</b>	<b>5 cartridges</b>

## **SHOTGUN OWNER'S RESPONSIBILITY**

As the owner of a shotgun, you have the responsibility and obligation of ensuring that any and all shooting activities are safe for everyone. This requires your personal commitment to carefully read, fully understand, and exercise the principles of proper firearm safety at all times.

## **LEGAL WARNING**

THE SHOTGUN IS SOLD ON THE CONDITION OF FOLLOWING THE SAFETY RULES AND INSTRUCTIONS FOR USE IN THIS MANUAL.

THE MANUFACTURER ACCEPTS NO LEGAL LIABILITY FOR TECHNICAL DAMAGES AND OTHER CONSEQUENCES SUCH AS DEATH, INJURY THAT MAY OCCUR DUE TO MISUSE.

**THE MANUFACTURER DOES NOT ACCEPT LEGAL LIABILITY IN THE FOLLOWING CASES:**

IMPROPER OR CARELESS HANDLING OF A SHOTGUN

USE OF INCORRECT, DEFECTIVE, IMPROPER CALIBER, HAND-LOADED, OR RELOADED AMMUNITION

INADEQUATE MAINTENANCE OF THE SHOTGUN RESULTING IN CORROSION OR DAMAGE TO THE SHOTGUN

RESALE IN CONTRADICTION OF ANY APPLICABLE LAWS OR REGULATIONS

CHANGING OR CONVERTING THE ORIGINAL AESTHETICS, WORKING MECHANISMS, ACCESSORIES OR

MECHANICAL CONFIGURATION OF THE SHOTGUN

DISCHARGING WITH CRIMINAL INTENT OR NEGLIGENCE

FAILURE TO UNDERSTAND, ADHERE TO, AND FOLLOW THE RULES OF FIREARM SAFETY WHEN USING OR HANDLING THE FIREARM OR ANY OTHER CIRCUMSTANCES OUTSIDE THE MANUFACTURER'S DIRECT OR IMMEDIATE CONTROL.

## FIREARM SAFETY

**IMPORTANT WARNING:** IT IS IMPORTANT FOR YOU TO RECEIVE PROPER TRAINING FROM A COMPETENT FIREARMS INSTRUCTOR OR AUTHORITY BEFORE BEGINNING TO SHOOT OR WHEN HANDLING THE FIREARM.

**MAKE SURE YOU HAVE FULLY READ AND UNDERSTAND THE USER'S MANUAL BEFORE USING YOUR SHOTGUN.**

**IMPORTANT WARNING:** FAILURE TO ADHERE TO THE RULES OF FIREARM SAFETY CAN RESULT IN SERIOUS INJURY, DEATH, OR DESTRUCTION OF PROPERTY.

### **1. COMPLETELY READ AND UNDERSTAND YOUR OWNER'S MANUAL GUIDELINES BEFORE USING YOUR FIREARM**

You should fully understand the function of all of the components and mechanics of the firearm. Before you remove the firearm out of the box, thoroughly read the owner's manual on how to properly carry, handle, load, unload, and store your new firearm. Know the rules of proper gun safety and exercise them at all times because failure to do so may result in death or injury to yourself or others.



## **2. ALWAYS LEARN THE SPECIFIC MECHANICAL AND HANDLING CHARACTERISTICS OF YOUR SHOTGUN**

All firearms are different thus it is important for you to understand how to properly carry, use, and handle each one according to its specific guidelines. Before using any firearm, one must completely familiarize themselves with the type of firearm and its specific safe handling procedures for loading, unloading, carrying, and storing.

### **NEVER**

Give the shotgun to any person who has not thoroughly familiarized himself or herself with all of the information, safety rules, and warnings in the owner's manual.

## **3) ALWAYS KEEP THE SHOTGUN UNLOADED UNTIL READY TO USE**

Firearms should be kept unloaded when not in use. Whenever you pick up a firearm, immediately engage the safety device and remove the magazine to visually inspect the chamber and confirm that it is clear. Always unload all ammunition from the chamber and remove the magazine after:

- 1) after shooting**
- 2) before putting the shotgun away**
- 3) before putting the it into holster**
- 4) when not in use**

## 5) when handing it over to another person

### NEVER

- Leave a loaded gun unattended, propped up against a surface, or out of your hands.
- Assume a firearm is unloaded, even if you used it last. Always check to make sure that there is no ammunition and the chamber is clear.
- Load a cartridge into the chamber until you are ready to fire.
- Carry or transport your firearm with live ammunition in the chamber.
- Pass a firearm to another person or accept a firearm from another person, until the cylinder or action is open and you have personally checked that the weapon is completely unloaded.
- Haul a loaded firearm openly or in a carrying case.
- Transfer or hand a loaded firearm to someone else.

## 4) ALWAYS KEEP YOUR FINGER OFF THE TRIGGER UNTIL YOU ARE READY TO SHOOT

When holding the firearm be sure to rest your finger on the trigger guard and along the side of the gun.

### NEVER

- Touch the trigger until you are ready to fire.
- Engage in horseplay while handling a firearm.
- Rely on the safety devices of the gun. Mechanical safeties are never foolproof and can wear out and malfunction overtime. Remember to always handle all firearms using proper gun safety guidelines.

## **5) ALWAYS KEEP THE GUN POINTED IN A SAFE DIRECTION**

A safe direction is one in which an accidental discharge cannot or would not cause injury or harm to yourself or others. Use extreme caution especially when loading and unloading your firearm. When handling any firearm always treat it as if it was loaded and ready to fire, even if you think it is empty. The recommended carrying position of your shotgun is with the hammer in de-cocked position.

### **NEVER**

- Point your firearm at anything you don't intend to shoot.
- Use a firearm under the influence of alcohol, drugs, or any other substances that may impair your judgment, skills, or physical abilities.
- Target shoot or hunt with a firearm when you are fatigued or too tired to operate the firearm safely.
- Use your firearm if you have an illness or disability that could compromise your judgment and the safety of yourself or others.

## **6) ALWAYS USE CORRECT AMMUNITION**

All firearms are manufactured to use a certain caliber or gauge of ammunition. Only use ammunition that the manufacturer has recommended. Always verify before loading that you have the correct ammunition that matches the manufacturer's recommendations. Using improperly reloaded or incorrect ammunition can cause death and injury. This can also damage or destroy your firearm which will void any warranty.

## NEVER

- Shoot the gun unless you know you have the proper ammunition.
- Use hand loaded, non-standard or reloaded ammunition.
- Fire ammunition that exceeds industry standard pressure specifications.
- Use old, soiled, or damaged ammunition.
- Use ammunition which does not feed reliably in your particular firearm as it may malfunction at a critical juncture.

## 7) **ALWAYS STORE YOUR FIREARM IN A SECURED STORAGE AREA TO PREVENT UNAUTHORIZED ACCESS OR USE FROM OTHER INDIVIDUALS**

There are many types of firearm storage devices as well as locking devices that attach directly to the firearm itself. Each individual must consider their particular circumstances so that the firearm is stored and maintained for optimal safety and security. Metal gun safes are recommended over open racks or glass front cabinets. Mechanical safeties built into the firearm can fail and should not be used as a substitute for safe gun handling and adherence to all firearm safety rules. Additionally, always store your ammunition locked up and secured separately from any firearms.

## NEVER

- Store or hide a loaded firearm.
- Leave your firearms where unauthorized access from other individuals can occur.
- Allow access to individuals who do not understand or follow the rules of proper gun safety.
- Leave an unsecured shotgun in a bed, drawer, closet, or any other vehicle that could allow access to children or other unauthorized individuals.
- Allow children under the age of 18 access to any firearms without close supervision and proper firearms safety training.

## 8) ALWAYS COMPLY WITH ALL LOCAL, STATE, AND FEDERAL LAWS THAT GOVERN THE OWNERSHIP, STORAGE, CARRYING, AND USE OF SHOTGUN

### NEVER

- Vandalize any public or private property by using it as a target.

## 9) ALWAYS BE AWARE OF YOUR TARGET AND WHAT IS BEHIND THE TARGET:

Be sure of your target and what is behind your target before pulling the trigger. Only shoot in proprietary

areas such as a shooting range or areas with a reliable background like slopes. Also, be aware of how far

your shot will travel in case you miss the target or the bullet ricochets.

## NEVER

- Fire in the direction in which there are people.
- Fire at a sound, movement, or a flash of color that you do not know what it is.
- Shoot directly upwards or at a high angle of elevation. Firing at or into the air can have enough energy to travel long distances and accidentally injure or kill someone.

## 10) ALWAYS WEAR EYE/ EAR/BODY PROTECTION

Gases and debris can cause injury so it is very important that one wears protective gear to preserve their

hearing and eyesight. Also, wear bright orange-colored materials that will make you noticed by others in an

area of at least 650 square meters.

## NEVER

- Fire your shotgun in a poorly ventilated area.

**IMPORTANT WARNING !!!** POSSIBLE LEAD EXPOSURE CAN OCCUR WHEN DISCHARGING FIREARMS IN A POORLY VENTILATED AREA, CLEANING THE FIREARM, OR HANDLING AMMUNITION. LEAD AND ITS COMPONENTS IS A SUBSTANCE KNOWN TO CAUSE BIRTH DEFECTS, REPRODUCTIVE DESTRUCTION/IMPAIRMENT, CANCER, OR OTHER SERIOUS HEALTH CONDITIONS AND INJURY. ALWAYS HAVE ADEQUATE VENTILATION AT ALL TIMES AND WASH YOUR HANDS AND OTHER CONTACT AREAS THOROUGHLY AFTER EACH EXPOSURE.

**11) ALWAYS HANDLE WITH EXTREME CARE IF YOUR SHOTGUN FAILS TO FIRE WHEN THE TRIGGER IS PULLED**

If the ammunition doesn't fire when you pull the trigger, STOP! and remember to always keep the firearm pointed in a safe direction. Keep your face away from the breech, then put the safety on, carefully open the action, unload the firearm and dispose of the cartridge safely. Always keep in mind that anytime there is a shell in the chamber, your firearm is LOADED and ready to fire. Even if you tried to shoot and the firearm did not fire, always treat it as if it could still discharge.

## **12) ALWAYS KEEP YOUR SHOTGUN IN THE SAME MECHANICAL AND STRUCTURAL CONFIGURATION AS IT WAS WHEN IT WAS BOUGHT**

This shotgun was produced under specific manufacturer guidelines and should not be altered or changed under ANY circumstances. Performing conversions by altering the trigger, mechanical components, safety mechanisms, or using any other products other those provided in the original box is **NOT RECOMMENDED** by the manufacturer, and could result death, bodily harm, or compromising your safety or the safety of others. Any alteration made to the firearm also voids the factory warranty. Like any mechanical device it is subject to normal wear and tear from use. In order to maintain optimal safety and performance it should be periodically serviced. You must regularly clean and lubricate your firearm to maintain its functionality, accuracy, safety, and reliability. Always before cleaning or lubricating any firearm make sure that you perform a safety check to make sure that the firearm is completely unloaded prior to performing any routine maintenance. If for some reason your firearm does require repairing, you must contact the importer for an approved service provider. Using unauthorized personnel to repair your firearm



will void your manufacturer's warranty.

## NEVER

- Alter, convert, or change your firearm from its original manufacturer's configuration.

**IMPORTANT WARNING!!!** THIS FIREARM WAS DESIGNED TO FUNCTION PROPERLY IN ITS ORIGINAL CONDITION. THE MANUFACTURER WILL NOT BE HELD LIABLE OR LEGALLY RESPONSIBLE FOR ANY ALTERATION PERFORMED ON THE FIREARM AFTER IT LEAVES THEIR CONTROL. THIS INCLUDES ANY ADDITION OR SUBSTITUTION OF PARTS OR ACCESSORIES THAT ARE NOT MANUFACTURED BY THE ORIGINAL MANUFACTURER ANY CHANGES MADE TO THE FIREARM IS SPECIFICALLY CONTRARY TO OUR INSTRUCTIONS AND WE EXPRESSLY DO NOT AUTHORIZE ANY CHANGES MADE AFTER MANUFACTURE. DO NOT JEOPARDIZE THE SAFETY OF YOURSELF OR OTHERS BY MAKING MODIFICATIONS TO YOUR FIREARM.

### **13) ALWAYS MAKE SURE THE BARREL IS CLEAR OF ANY OBSTRUCTIONS BEFORE SHOOTING**

Before loading always perform a safety check to make sure that there is no ammunition in the chamber or magazine.

Examine the barrel for any obstructions or debris such as excess lubricant, dirt, or grease. If the bore is obstructed it

can cause increased pressure causing the barrel to bulge or burst during use. Always use a cleaning rod and patch

to remove any residues or obstructions in the barrel. Be familiar with your firearm. If the noise or recoil seems weak then STOP! And proceed to unload your firearm and check to make sure nothing is lodged in the barrel.

**NEVER**

- Try to shoot out an obstruction by loading another shell and firing.

## **SERIAL NUMBER OF THE SHOTGUN**

The serial number is located on various parts of the shotgun. Each serial number is specific to that shotgun and is used for identification and registration. It is recommended that you record your serial number in your manual and keep the information in a secured location.

## **LOADING THE SHOTGUN**

1- First, point the shotgun in a safe direction. Remember, a safe direction means that the gun is pointed so that even if it were to go off, it would not cause injury, damage, or death. Always perform a safety check to make sure that the chamber is empty.

2- When the magazine is empty, the bolt catch lever holds the bolt open at the rear. Press the magazine release to remove the empty magazine and insert a loaded magazine. Remember to only use ammunition that is recommended by the manufacturer.

3- Push down the bolt catch lever with the thumb of the shooting hand and this will allow the bolt to move forward and chamber a round.

## PARTS OF THE SHOTGUN

**YOUR GUN IS LOADED AND READY TO FIRE RIGHT NOW**

**IMPORTANT WARNING: ALWAYS UNLOAD YOUR FIREARM IMMEDIATELY AFTER SHOOTING**

### UNLOADING THE SHOTGUN

- 1-) Point the shotgun in a safe direction. Remember, a safe direction means that the gun is pointed so that even if it were to go off, it would not cause injury, damage, or death.
- 2-) Keep your fingers off the trigger and remove the magazine.
- 3-) Pull back the charging handle one or more times to ensure the chamber is empty. Watch for a live round or empty case to be ejected. Pull the charging handle fully rearward and lock the bolt with the bolt catch lever.
- 4-) Make sure the last round in the chamber has been extracted and ejected. Visually and physically check the chamber and the magazine well to make sure the shotgun has been fully unloaded. Perform a safety check by physically inserting your index finger in the chamber to feel for the presence of a round or cartridge case in the chamber.

## DISCHARGING THE SHOTGUN



- |                                   |                       |                                       |
|-----------------------------------|-----------------------|---------------------------------------|
| 1. Choke (3 Pieces)               | 12. Action            | 15. Forend Strap (front)              |
| 2. Fore sight                     | 13. Operating Handle  | 16. Slide spring                      |
| 3. Barrel                         | 14. Barrel fixing pin | 17. Gas Piston                        |
| 4. Hand Swaddling                 |                       | 18. Carrier Arm Tube                  |
| 5. Carrying Handle                |                       | 19. Barrel Fixing Nut                 |
| 6. Aluminum Housing               |                       | 20. Handheld Swaddle Fastening Nut    |
| 7. Butt Cap Base Screws           |                       | 21. Aluminum Housing Connection Screw |
| 8. Shock absorbing buttstock base |                       | 22. Magazine (2 Pcs)                  |
| 9. Butt strap                     |                       |                                       |
| 10. Trigger unit                  |                       |                                       |
| 11. Action carrier                |                       |                                       |

## OPT VM G1 20 SHOTGUN DISASSEMBLY INSTRUCTION

**MANUFACTURER'S WARNING:** THIS SHOTGUN YOU HAVE PURCHASED IS DESIGNED TO WORK WITH ORIGINAL PARTS. IT IS YOUR RESPONSIBILITY TO ENSURE THAT THE PARTS YOU HAVE PURCHASED ARE SUITABLE FOR YOUR SHOTGUN, THAT THEY HAVE BEEN INSTALLED PROPERLY, AND THESE PARTS HAVE NOT BEEN REPLACED. THE GUARANTEE THAT OUR COMPANY MAKES ABOUT THE SAFE AND EFFECTIVE OPERATION OF YOUR SHOTGUN COVERS ONLY THE REPLACEMENT OF PARTS MANUFACTURED IN THE FACTORY WHEN MAKING CHANGES TO THE SHOTGUN. THE USER IS FULLY RESPONSIBLE FOR THE REASSEMBLY AND OPERATION OF THE SHOTGUN IN THE EVENT OF THE INSTALLATION OF THE SHOTGUN.

**IMPORTANT WARNING:** BEFORE STARTING TO DISASSEMBLE THE SHOTGUN, 1) POINT THE SHOTGUN IN A SAFE DIRECTION 2) BE SURE TO REMOVE THE MAGAZINE 3) MAKE SURE THAT THE CHAMBER IS

EMPTY.

1. Unscrew and remove the forend fixing nut.

2. Remove the forend by pulling it towards you.



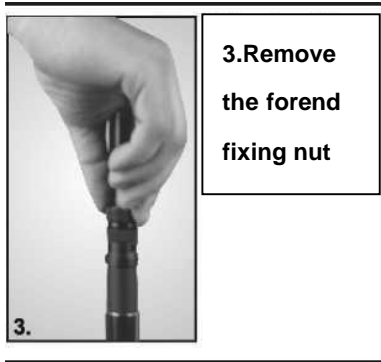

4. Pull the mechanism slightly back and push the barrel forward. As the barrel is coming out, slowly release the mechanism to empty the recoil spring/mechanism carrier.

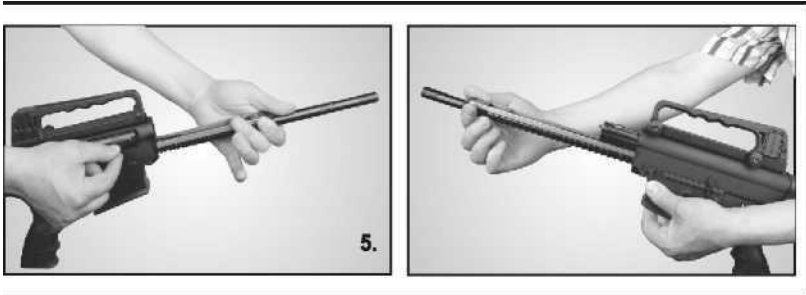

5. Remove the operating handle from the mechanism.



6. ATTENTION: Remove the mechanism by pulling the mechanism back 3 cm and turning the cartridge ramp button down.

6. To unscrew the carrier, turn down the catch located on the front-upper part of the magazine on the left side of the shotgun. This process will allow the carrier to exit.

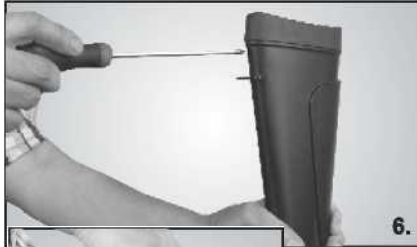

7. To access the top cover assembly connection screw located in the butt, unscrew the impact absorbing butt base with a screwdriver.

8. Insert the allen wrench into the aluminum housing connection screw and loosen the screw for 4 full turns. Gently tap the joint and the slot to move the connecting screw forward. After the aluminum housing starts to separate from the plastic housing, loosen the screw for another 2-3 turns. Gently tap the joint again to further separate the aluminum body from the plastic bottom. As you do this,

you will notice an ever-widening gap. When this gap reaches approximately 2-3 centimeters, you can remove the connecting screw and washer and completely separate the aluminum body from the plastic bottom

9. It is enough to disassemble the shotgun for cleaning and lubrication operations.





## CHOCK INTRODUCTION



THE OPT VM G1 20 SHOTGUN IS WITH 3 MOBILE CHOCKS (FULL, HALF AND ZERO CHOCKS). EACH CHOCK IS DEFINED BY THE NOTCHES ON IT (FULL CHOCK = 1 NOTCH; HALF CHOCK = 3 NOTCHES; ZERO CHOCK = 5 NOTCHES). THERE IS ALSO A CHOCK SWITCH IN THE CHOCK BOX. BEFORE ATTACHING ONE OF THE CHOCKS TO THE GUN, MAKE SURE THAT THE GUN IS UNLOADED AND POINTED IN A SAFE DIRECTION. TO INSTALL THE CHOCK, PLACE IT ON THE BARREL END AND TURN IT CLOCKWISE WITH YOUR HAND USE THE CHOCK SWITCH TO TIGHTEN THE CHOCK.

## MOBILE CHOCK WARNING

NEVER BEND DIRECTLY OVER THE MUZZLE, IGNORING SAFETY RULES, OR ATTEMPT TO CHANGE SHOCKS WHILE THE SHOTGUN IS LOADED. NEVER FIRE WHEN THE MOBILE CHOCK DOES NOT FIT FULLY AND FIRMLY TO THE BOTTOM OF THE GROOVE AT THE END OF THE BARREL, WHEN DISTORTIONS OCCUR IN THE CHOCK OR IN THE BARREL GROOVE. OTHERWISE, THE BARREL WILL BE DAMAGED. MORE IMPORTANTLY, AN INCOMPLETE CHOCK TO THE BARREL MAY CAUSE DEATH, INJURY OR OTHER DAMAGE BY EJECTING FROM THE MUZZLE OF THE BARREL OVERQUICKLY. DO NOT FIRE WITHOUT ATTACHING ANY MOBILE CHOCK TO THE MUZZLE. IN SUCH A SITUATION, IT WILL BE UNPREDICTABLE WHAT KIND OF DISTRIBUTION PATTERN THE SCATTERING FROM THE BARREL WILL FOLLOW. IN ADDITION, THE GROOVE IN THE BARREL WILL DETERIORATE. AFTER THAT, NO CHOCK WILL BE ATTACHED TO THE BARREL AND THE REPAIR WILL BE QUITE HARD FOR YOU.

**IMPORTANT WARNING:** BEFORE YOU START CLEANING YOUR SHOTGUN, MAKE SURE THAT THE SHOTGUN IS UNLOADED AND POINTED IN A SAFE DIRECTION.

**LUBRICATION WARNING:** SHOOTING WITH SHOTGUNS IN WHICH MATERIALS SUCH AS OIL AND DIRT COMPLETELY OR PARTIALLY BLOCK THE INSIDE OF THE BARREL CAN DAMAGE THE SHOTGUN ITSELF, AS WELL AS BE HURTFUL TO THE PERSON USING THE SHOTGUN AND OTHER PEOPLE. BEFORE FIRING, MAKE SURE THAT THE BARREL AND THE CHAMBER ARE DRY AND NOT CLOGGED WITH ANY HARD MATERIAL. FIRING WHILE THERE IS A BLOCKAGE IN THE BARREL CAN CAUSE DEATH AND INJURY BY DAMAGING THE SHOTGUN. REMEMBER THAT YOU ARE RESPONSIBLE FOR THE MAINTENANCE AND STORAGE OF YOUR SHOTGUN YOURSELF.

### **GUARANTEE**

The manufacturer undertakes a one (1) year warranty to the retail customer for defects caused by materials and workmanship from the date of sale. The manufacturer or importer shall have the right of discretion as to whether the parts, workmanship or replacement are the responsibility of the customer. The manufacturer or importer has the right to conduct research, investigation and testing on the shotgun in order to determine the damage claim under the warranty.

### **SITUATIONS OUTSIDE THE SCOPE OF THE WARRANTY**

Making changes to the shotgun, using the shotgun out of purpose, accidental damage, firing with hand loaded or reloaded cartridges, firing while there are blockages in the barrel, or damage caused by failure to perform regular and necessary maintenance invalidates the warranty coverage. In addition, repairs or replacements performed on the shotgun by unauthorized persons will also void the warranty.

Please contact the manufacturer or marketing company for more information about how you can get service for your shotgun during the warranty.



**OPTIMUM  
ARMS**

**THE WISE CHOICE**